

# Porcelain Cutting Guide

Installation Guide

Version: 1.0  
Issue: May 2024

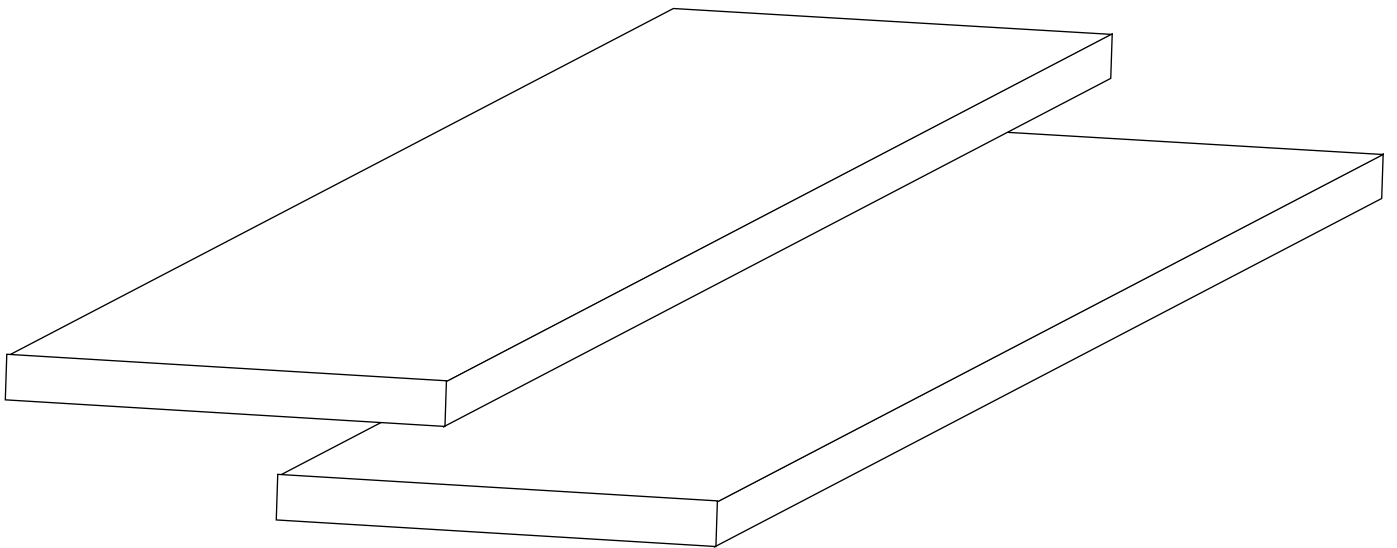

[rynosystems.com](https://rynosystems.com)

# Cutting Guide

The high strength of porcelain means it is occasionally challenging to cut. Issues can be overcome by employing the techniques below.

## Equipment

Porcelain must be cut with a 'porcelain blade', rather than a standard masonry blade. Porcelain blades are manufactured with diamond, specifically to be used with porcelain. They feature a continuous rim which ensures a precise cut as opposed to a large segment blade which can cause chipping and cracking.

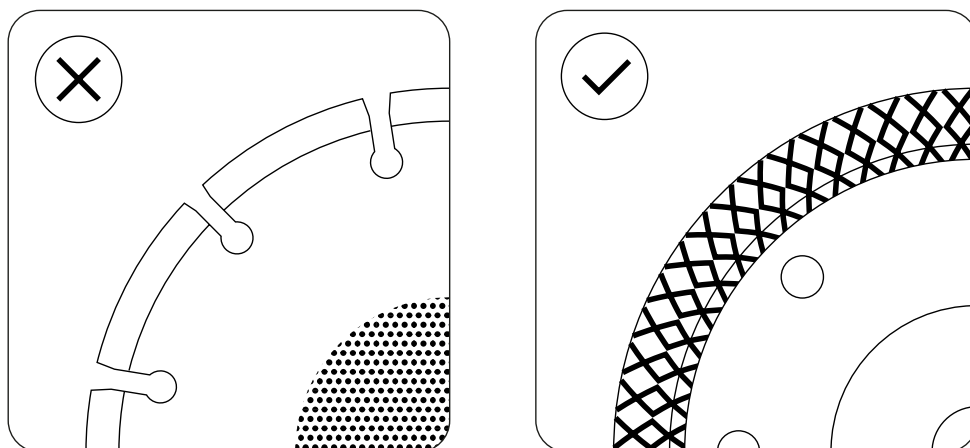

## Additional Equipment

We recommend using a cutting bench saw if possible. This will offer consistent power and help give a nice straight edge. If this isn't possible, an electric grinder is a good alternative (as opposed to a petrol saw). Ensure you use plenty of water when cutting to keep the blade cool and sharp.

## Safety

- Safe working practise should be observed at all times during the installation process and all necessary Personal Protective Equipment (PPE) should be worn
- Always use correct PPE throughout installation

- 1.** Ensure the tile is on a flat surface to reduce vibration during the cut.
- 2.** Score your cut line first with a blade: particularly when cutting curves.
- 2.** Cut a small section into the tile (4-5cm), full depth at each end to reduce cracking and splintering at the end of the cut.
- 3.** Cut slowly. Moving the tile too quickly will create more vibration, leading to breakages

**Head Office**

Castlepoint  
Castle Way  
Ellon  
AB41 9RG

**The Studio**

2 Sutton Lane  
off Clerkenwell Road  
London  
EC1M 5PU

**Telephone:**

+44 (0)203 967 3500

**Email:**

[sales@rynosystems.com](mailto:sales@rynosystems.com)

Ryno Ltd  
Registered no: 09623250  
VAT no: GB 214 3190 46

Registered address: Europa House,  
Alford Road, Cranleigh, GU6 8NQ